

# CERTIFICATE

## EU Type – Examination

According to Directive 2014/33/EU, (Module B, annex IV)  
Certificate No: **LF/KSA/A-C-0178/17**

Identification No of Certification body: MIRTEC s.a  0437

Name & Address  
of the Certificate Holder :  
of the Manufacturer: **DELTATEK** ELEVATOR SAN. TİC. LTD. ŞTİ.  
İMES SANAYİ SİTESİ C BLOK 308 SOKAK No:6 YUKARI  
DUDULLU ÜMRANIYE 34776 / İSTANBUL / TÜRKİYE

Date of Submission for EU Type-Examination : **10/08/2017**

Product of Safety Component: **Landing door locking device**

Type: **DK02A**

Applicable Standards: 2014/33/EU, annex I, IV  
EN81-50:2014 5.2  
EN81-20:2014 5.3.8, 5.3.9, 5.3.10

Examination Period: August-December 2017

Date & No of examination report: LF/KSA/A-R-0178/17, 07/12/2017

Test Laboratory : MIRTEC S.A.

Place of testing: ÇERKEŞLİ OSB MAH. İMES OSB 18. CAD. A4/2 No.  
41/2 DİLOVASI /KOCAELİ / TÜRKİYE  
7/12/2017 , GTL- ENV-173/17 (GTLs-694A)

Date & No of laboratory Report:

Documents annexed:  
to the Certification: Product description, Drawings ,Installation &  
Maintenance instructions, Material list

Field of application : Semi-automatic landing doors for lift  
Electrical power supply: 230V AC - 1.0A

### Validation conditions / Additional instructions:

The production of car door locking device is under the surveillance of the certification body.  
For all changes the certificate holder must inform the certification body.

### Result of the examination - Declaration:

**Herewith we certify that the type of the product mentioned above, meets the basical requirements of the relevant Directive and Norms for the mentioned Field of application.**

Only the products detailed in the test report have been subjected to tests.

Date of issue:

**13.12.2017**

For EBETAM A.E

  
I. DIMITRIADIS  
Director of Athens Office

Certification department for lifts

  
C. SPILIOPOULOS  
Inspector of Lifts

EBETAM A.E.  
CERT - safecomp / EN 02 (5.0 / 24.10.2016)  
AET :29350



- COMPONENT NO. PART NUMBER
- 1 DM00601-Sol (DK02A-Aluminum left box) 1
  - 2 DM00602 (DK02A- locking tongue) 1
  - 3 DM00605 (DK02A-Distance shaft) 1
  - 4 DM00113-tongue contact 2
  - 5 DM00112-metallic washer 4
  - 6 DM00613 (DK02A bolt. screw) 1
  - 7 DM00608 (DK02A-arm. shaft) 1
  - 8 DM00603 (DK02A-locking arm) 1
  - 9 DM00607 (DK02A-plug contact spring wound screw) 2
  - 10 DM00606 (DK02A-plug contact bearing bush) 2
  - 11 DM01818-plug contact spring fixing sheet 2
  - 12 DM00114- tongue contact bridge 1
  - 13 4 lük Terminal 1
  - 14 DM00604 (DK02A-locking shaft) 1
  - 15 DM00523-lock key 1
  - 16 DP00607 (DK02A-Tongue rubber contact centerin pin) 1
  - 17 DP00603 (DK02A-Flip Kontakt Muhafazası) 1
  - 18 DP00609 (DK02A-plug contact rubber) 1
  - 19 DP00605 (DK02A-Tongue rubber) 1
  - 20 DP00606 (DK02A-Bearings of pin spring) 1
  - 21 M4X10 YHB (ISO 7046-1) 2
  - 22 2,9x9,5 YBB 4
  - 23 M9 AS ( DIN 6799) 1
  - 24 M4X20 YBB (ISO 7045) 1
  - 25 M4 TP (DIN 6798) 1
  - 26 M4X16 YHB (ISO 7046-1) 4
  - 27 M4X6 YBB 1
  - 28 2,9X6,5 YHB 1
  - 29 M5 AS (DIN 6799) 1
  - 30 M3X8 YHB (ISO 7046-1) 1
  - 31 M6X10 YHB 2
  - 32 DG00103-contact silver 4
  - 33 DK02A-plug contact silver 2
  - 34 DP00516-Kilitleme Mill Tamponu 2
  - 35 9X1,5 Oring 1
  - 36 DY00503-DK01 Tongue spring 1
  - 37 DY01802-Tongue rubber contact spring 1
  - 38 of five male terminal 1
  - 39 female quintet terminal 1
  - 40 DK02A-plug contact cable-1 1
  - 41 DK02A-plug contact cable-2 1
  - 42 DK02A-Tongue contact cable-1 1
  - 43 DK02A-Tongue contact cable-2 1
  - 44 DK02A-Ground cable 1
  - 45 DMYSK02-5.5mm marble 1
  - 46 DP00512-Wheel rim 1
  - 47 DM00516-Arm of lock 1
  - 48 DM00514-Wheel axle 1
  - 49 M8 S ( ISO 4034) 2
  - 50 M7 AS ( DIN 6799) 1
  - 51 M6 P 2
  - 52 M6 S 1
  - 53 DP00513-Wheel tire 1
  - 54 DM00515-iron sheet of opposite of lock 1
  - 55 M5X16 YHB 2
  - 56 M6 KS 2
  - 57 M6X40 AK (ISO 4016) 1
  - 58 DP00601-Sol (DK02A-left lock glass) 1
  - 59 DP00611-T(DK02A collective plug contact bridge) 1

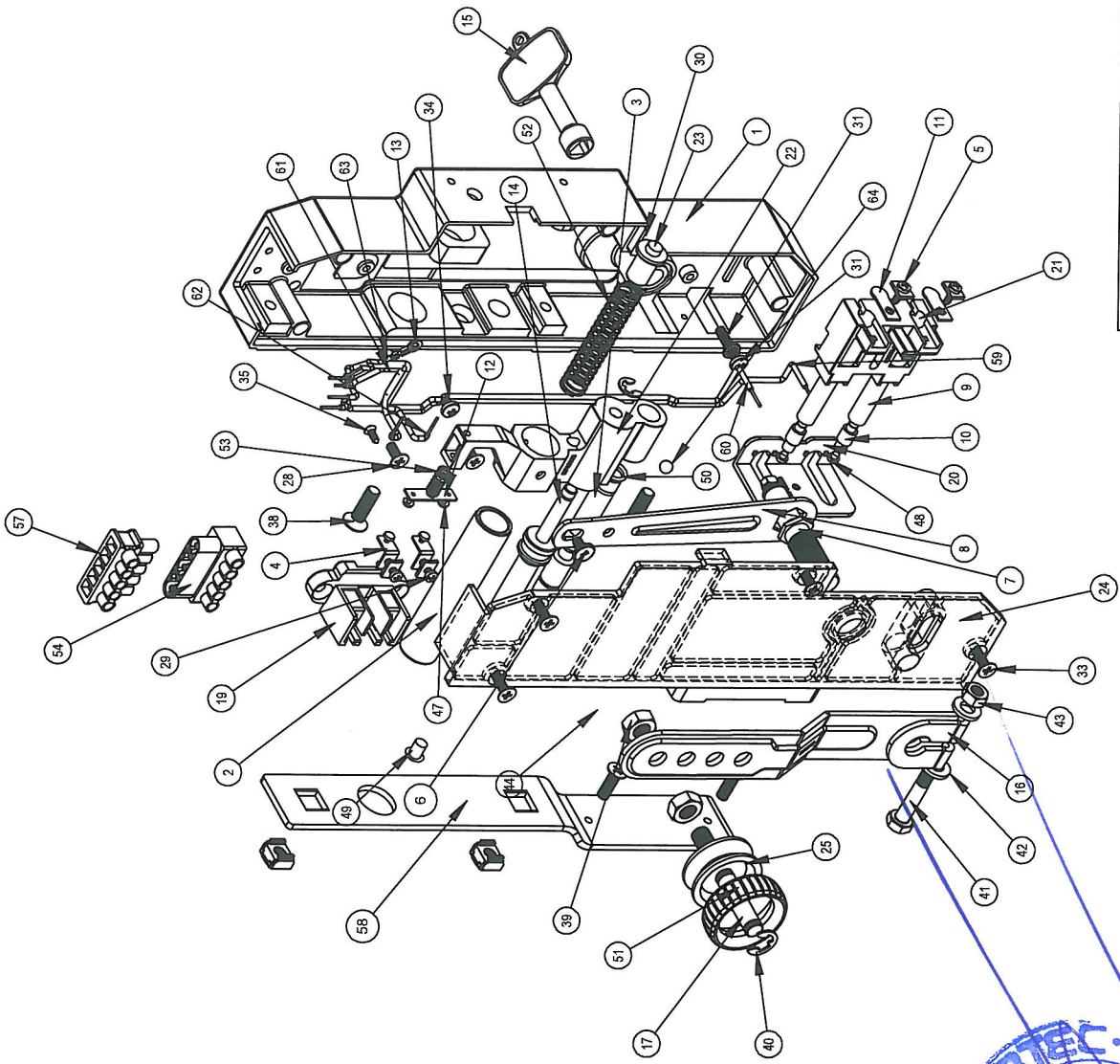

PART WEIGHT		1300 Gr	
KOD	DK02A-Sol	STAGE PROCESS	Introduction to Quality Control
PRODUCT NAME		CONT. METHOD	
MATERIAL		TOLERANCE	
DATE OF PUBLICATION	05/03/2013	CONT. FREQUENCY	
REV. NO / DATE		NO PICTURE	
SCALE ÖLÇEK	1/3	APPROVAL	

